

INTERLOCKING VINYL FLOORING INSTALLATION

We recommend that your interlocking vinyl flooring is fitted by a professional flooring installer over the recommended Vinyl LOC underlay. This is designed to prevent the planks or tiles from sliding or becoming damaged due to unevenness in the subfloor. For more detailed installation instructions, including subfloor preparation and conditioning, please refer to the Technical Manual.

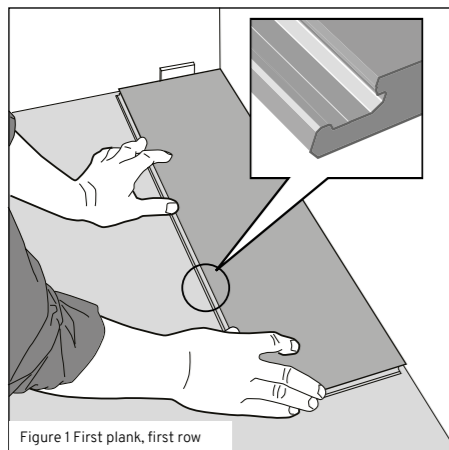

Figure 1 First plank, first row

FIRST TILE or PLANK, FIRST ROW

The boards are laid without glue/adhesive. Start to lay the floor in the left-hand corner of the room. A minimum expansion gap of 4mm should be left around the installation perimeter and anything protruding from the subfloor. For larger installations an expansion gap of 1mm per linear metre of room length should be used. e.g. a room 8m x 4m would require an expansion gap of 8mm around the entire perimeter of the room and around anything protruding from the floor. **Use small offcuts of the tile/plank as spacers between the planks and the walls to help achieve the correct size gap.**

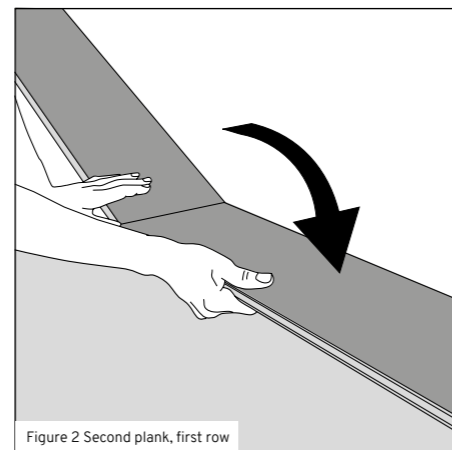

Figure 2 Second plank, first row

SECOND TILE or PLANK, SECOND ROW

Press the short end of the next tile/plank at an angle to the first one, and then lay down. Complete the first row in the same way.

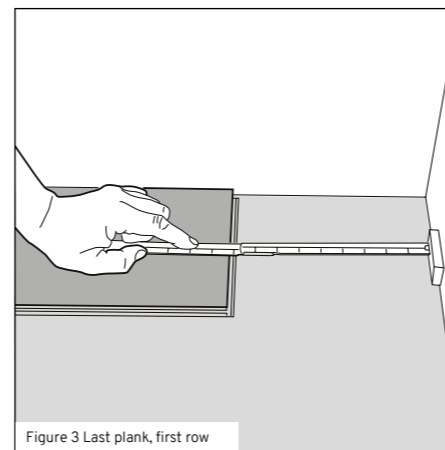

Figure 3 Last plank, first row

LAST TILE or PLANK, FIRST ROW

Insert correct sized spacer between the end of the first row and the wall to ensure the correct expansion gap is left. Measure the length of the last tile/plank to fit. Cut the last panel to correct length, recommended minimum length is 350mm.

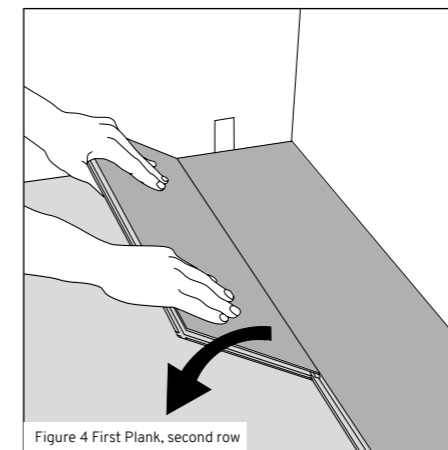

Figure 4 First Plank, second row

FIRST TILE or PLANK, SECOND ROW

Insert spacer between the end of the first row and the wall (expansion gap). Start the new row with the leftover piece from the last row. Insert the tile/plank at an angle against the plank in the previous row, press forward and fold down at the same time. Always try to stagger the short joints approx. 150mm from a short joint in the previous row.

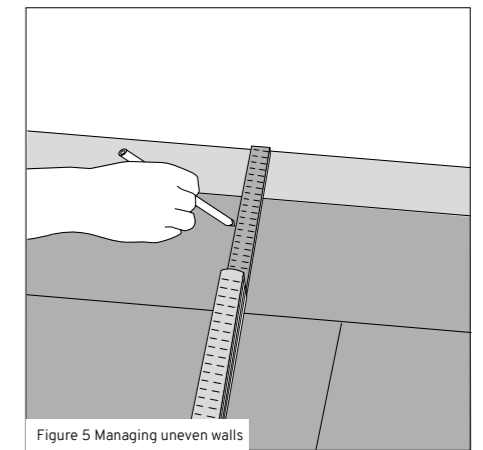

Figure 5 Managing uneven walls

MANAGING UNEVEN WALLS

If the wall is uneven, the floorboards should be marked or scribed to its contours. Mark the floorboards with the contour of the wall. Don't forget to include the required expansion gap to the wall.

To cut the planks to fit the last row, position them one at a time directly over the previous row in the direction you'll be laying them. Hold them firmly in place. Then line up a third board on top. Use the edge of this board to mark the cutting line with a pencil on the board beneath. **Remember to allow for the expansion gap.**

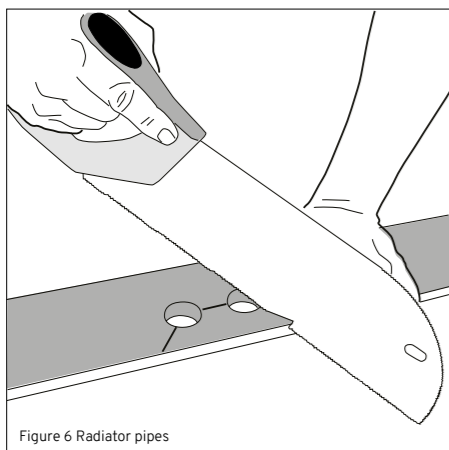

Figure 6 Radiator pipes

RADIATOR PIPES (Fig.6 & 7)

Principle cut out – mark the centre of the holes on both the long and short sides using a carpenter's square and a pencil. Where the marks cross drill a pilot hole using a thin #6 or #8 drill bit. Further drill the hole with a spade bit wide enough to accommodate both the diameter of the pipe and the required expansion gap. Cut around as shown with a saw or with a sharp utility knife. Install the floor plank. If necessary, put a bead of contact glue on the cut piece and replace.

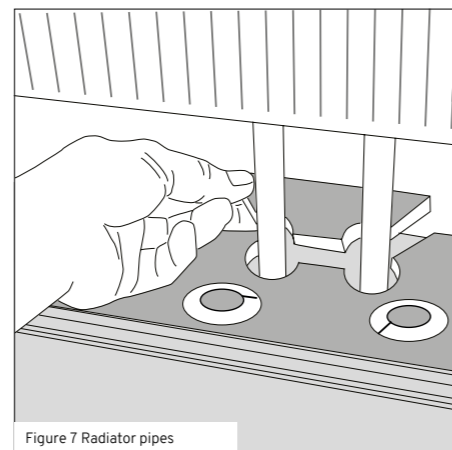

Figure 7 Radiator pipes

Insert a spacer directly behind the inserted piece to wedge it in place ensuring that the correct sized expansion gap has been left. Leave this in place until the glue has hardened.

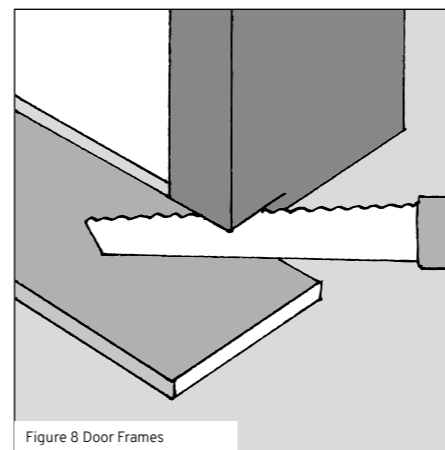

Figure 8 Door Frames

DOOR FRAMES

When installing Interlocking plank/tile around a door frame, cut into the door frame with a handsaw, using an off cut plank/tile and some underlay as a guide for the height and the amount to trim off the door frame. Slide the cut piece under the door frame.

ADJOINING OTHER FLOOR COVERINGS

When adjoining other floor coverings, finish the Interlocking plank/tile in the doorway. An appropriate expansion gap should be left between the Interlocking plank/tile and the adjoining floor covering. This can be covered using a suitable threshold or diminishing strip later.

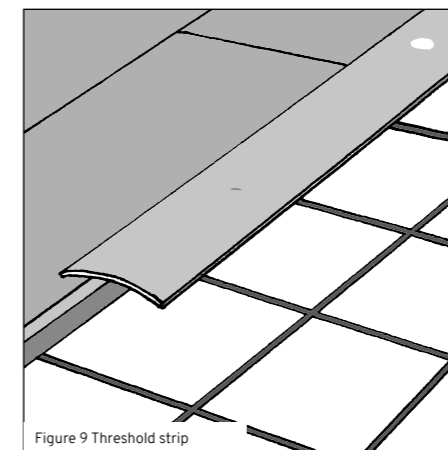

Figure 9 Threshold strip

INSTALLING ACROSS MULTIPLE ROOMS

Finish the Interlocking plank/tile in the doorway on either side and allow a break between the two floors of double that left around the perimeter. A suitable threshold strip can then be installed to cover the resultant gap. **Place two small off cut pieces of Interlocking plank/tile back to back to gauge the correct gap size.**

When installing a threshold never mechanically fix direct to the Interlocking plank/tile; instead affix to the subfloor and allow sufficient space between the top edge of the threshold and the surface of the Interlocking plank/tile so as to allow movement into the expansion gap.

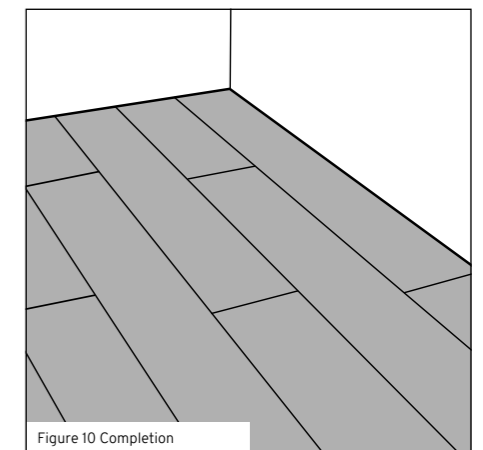

Figure 10 Completion

COMPLETION WORK

Interlocking planks/tiles are designed as floating floors hence the floor covering can be walked on directly after it is installed. Remove all the spacers and wedges from the edge expansion gaps.

Skirting boards, base boards, quadrants or scotia can be used to conceal the expansion gap, however they should never be fitted directly onto the surface of the interlocking plank/tile. **Leave a small gap between the two, allowing for the natural movement of the plank underneath the skirting or scotia.**